

REV.	ECN NO.	DESCRIPTION	DATE	DESIGN

NOTES:

SPECIFICATION:

1. CURRENT RATING: 3.0A MAX
2. VOLTAGE: 100 VAC
3. TEMPERATURE RANGE: -30 °C ~ 85 °C
4. CONTACT RESISTANCE: 40 MILLIONHM MAX
5. INSULATION RESISTANCE: 100 MEGOHMS MIN.
6. INSERTION FORCE : 5N~20N
7. UNMATING FORCE: 8N~20N
8. DURABILITY: 10,000 CYCLES

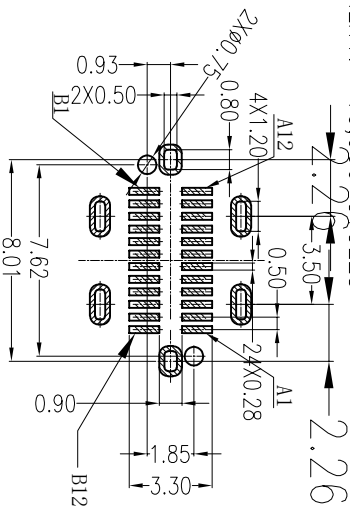
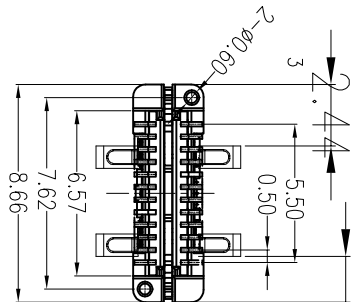
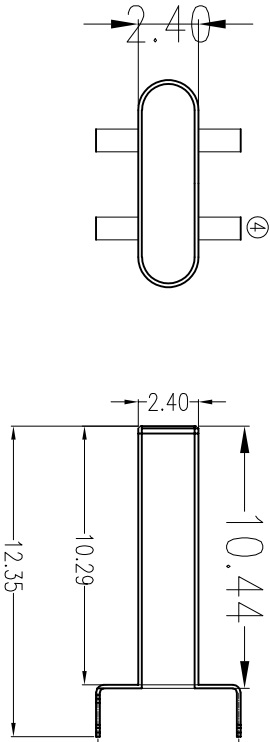
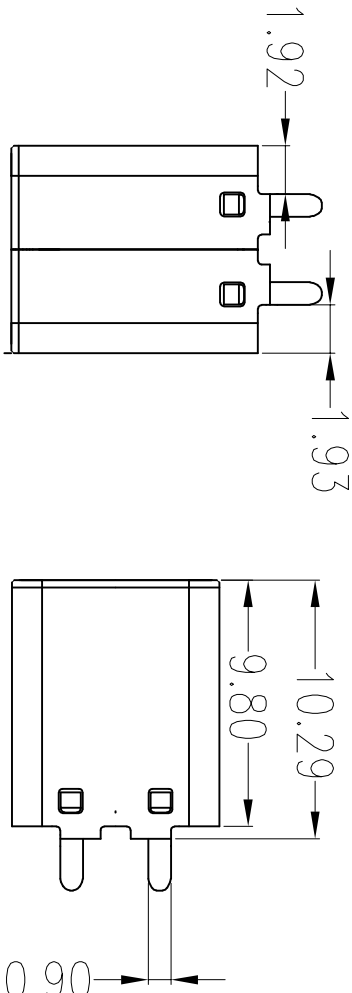

RECOMMENDED PCB LAYOUT(±0.80/±0.05)
COMPONENT SIDE(GENERAL TOLERANCE±0.05)

A1	GND	B12	GND
A2	SSTXP1	B11	SSRXP1
A3	SSTXN1	B10	SSRXN1
A4	VBUS	B9	VBUS
A5	CC1	B8	SBU2
A6	DP1	B7	DN2
A7	DN1	B6	DP2
A8	SBU1	B5	CC2
A9	VBUS	B4	VBUS
A10	SSRXN2	B3	SSTXN2
A11	SSRXP2	B2	SSTXP2
A12	GND	B1	GND
PIN	SIGNAL NAME	PIN	SIGNAL NAME

5	COVER	HIGH TEMPERATURE PLASTIC	LCP BLACK	1PCS
4	SPRING	STAINLESS STEEL	---	2PCS
3	LATCH	STAINLESS STEEL	TIN-80~120U Min./Ni base:50U Min Plated	1PCS
2	SHELL	STAINLESS STEEL	Ni:50U Min Plated	1PCS
1	TERMINAL HOUSING	HIGH TEMPERATURE PLASTIC	LCP BLACK/CONTACT: Au:3u Min Ni base:80u Min	2PCS
NO. DESCRIPTION		MATERIAL	REMARKS	QTY
TOLERANCE		NAME(INTENDED USE)	TITLE:	
X.X ±0.30 X.* ±10°		PART NO.	CM type-c24p立贴公头四脚	
.XX ±0.20 .X* ± 8°		DESIGN: ZXM	DRAWG NO. FY23-47TC242F4111-04	
.XXX ±0.10 .XX* ± 5°		CHED:	SCALE 1:1	
UNITS mm		APPD:	SHEET 1/2	
MATERILA			REV. A	
FINISH				

Fluxou 广东富源兴业精密科技实业有限公司
Guangdong Fluxou Precision Electronic Technology Co., Ltd.

CUSTOMER

5

4

2

1

REV.	ECN NO.	DESCRIPTION	DATE	DESIGN

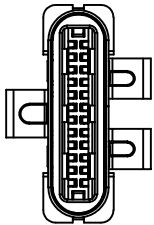
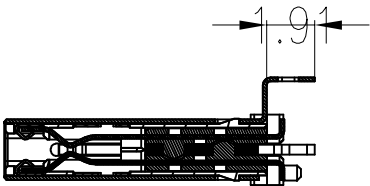
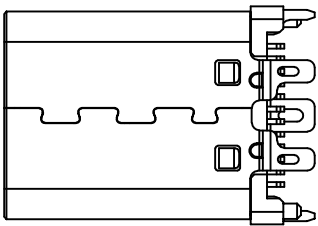
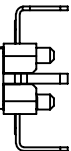
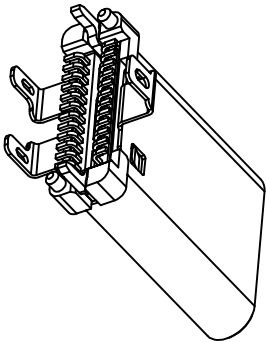
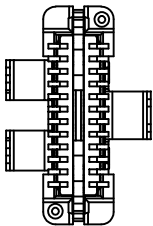

剖面 A-A

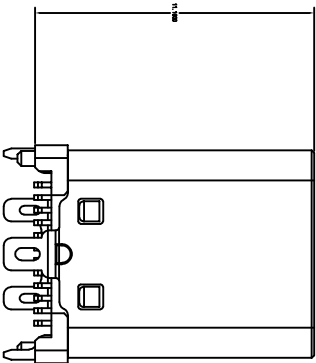
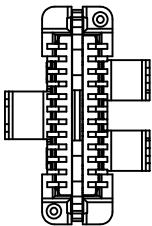

TOLERANCE				NAME(INTENDED USE)			
				CUSTOMER DRAWING			
X:X	±0.30	X"	±10"	PART NO. F723-47TC242F4111-04			
.XX	±0.20	.X"	± 8"				
.XXX	±0.10	.XX"	± 5"				
UNITS	mm			DESIGN: ZXM			
MATERILA	-----			CHED:			
FINISH	-----			APPD:			
				DRAWG NO. F723-47TC242F4111-C			
				SCALE	SHEET	REV.	
				1:1	1/2	A	